

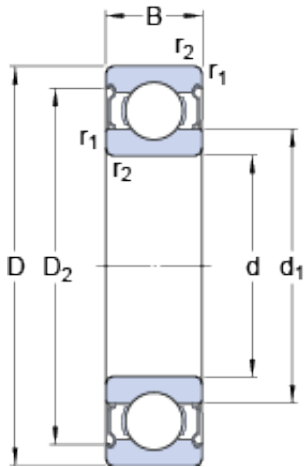

KORTON INDUSTRIAL LIMITED



6208-2Z Bearing 2D drawings and 3D CAD models

SKF ball bearing 6208-2Z deep groove ball bearing

Bearing No. 6208-2Z

| | |
|---|--------------------------|
| Size | 80x40x18 mm |
| Bore Diameter | 80 mm |
| Outer Diameter | 40 mm |
| Width | 18 mm |
| d | 40 mm |
| D | 80 mm |
| B | 18 mm |
| d ₁ | 52.6 mm |
| D ₂ | 69.8 mm |
| r _{1,2} - min. | 1.1 mm |
| d _a - min. | 47 mm |
| d _a - max. | 52.5 mm |
| D _a - max. | 73 mm |
| r _a - max. | 1 mm |
| Basic dynamic load rating - C | 32.5 kN |
| Basic static load rating - C ₀ | 19 kN |
| Fatigue load limit - P _u | 0.8 kN |
| Reference speed | 18000 r/min |
| Limiting speed | 9000 r/min |
| Calculation factor - k _r | 0.025 |
| Calculation factor - f ₀ | 13.8 |
| Category | Single Row Ball Bearings |
| Inventory | 1.0 |
| Manufacturer Name | SKF |



KORTON INDUSTRIAL LIMITED

| | |
|---------------------------------|---|
| Minimum Buy Quantity | N/A |
| Weight / Kilogram | 0.382 |
| EAN | 7316570420982 |
| Product Group | B00308 |
| Enclosure | 2 Metal Shields |
| Precision Class | ABEC 1 ISO P0 |
| Maximum Capacity / Filling Slot | No |
| Rolling Element | Ball Bearing |
| Snap Ring | No |
| Internal Special Features | No |
| Cage Material | Steel |
| Internal Clearance | C0-Medium |
| Inch - Metric | Metric |
| Long Description | 40MM Bore; 80MM Outside Diameter; 18MM Outer Race Diameter; 2 Metal Shields; Ball Bearing; ABEC 1 ISO P0; No Filling Slot; No Snap Ring; No Internal Special Features |
| Category | Single Row Ball Bearing |
| UNSPSC | 31171504 |
| Harmonized Tariff Code | 8482.10.50.68 |
| Noun | Bearing |
| Keyword String | Ball |
| Manufacturer URL | http://www.skf.com |
| Manufacturer Item Number | 6208-2Z |
| Weight / LBS | 0.84 |
| Outer Race Width | 0.709 Inch 18 Millimeter |
| Outside Diameter | 3.15 Inch 80 Millimeter |
| Bore | 1.575 Inch 40 Millimeter |
| d ₁ | 52.6 mm |
| D ₂ | 69.8 mm |
| | |



KORTON INDUSTRIAL LIMITED

| | |
|--------------------------------|---------|
| $r_{1,2}$ min. | 1.1 mm |
| d_a min. | 47 mm |
| d_a max. | 52.5 mm |
| D_a max. | 73 mm |
| r_a max. | 1 mm |
| Basic dynamic load rating C | 32.5 kN |
| Basic static load rating C_0 | 19 kN |
| Fatigue load limit P_u | 0.8 kN |
| Calculation factor k_r | 0.025 |
| Calculation factor f_0 | 13.8 |
| Mass bearing | 0.38 kg |